

## ROLLERS FOR BIKES WITHOUT A RACK

### IMPORTANT INFORMATION

- In 2016 a new set of rollers were introduced, replacing the original conical roller
- These Rollers are compatible with all L and E version bikes

### FITTING THE FORWARD ROLLERS

Remove the existing rollers by unscrewing the fixing bolts from the centre. The new rollers should be fitted to the rear frame as shown (fig. 1) with the washer between the roller mount and the spacer. The roller is not symmetrical; the longer side of the central hub (fig. 1, 2) should face inwards towards the roller mount, with the shorter side facing the head of the bolt. You can add some chain lubricant or light oil between the plastic roller and spacer when assembling the parts, though this is not essential.

Fig. 1

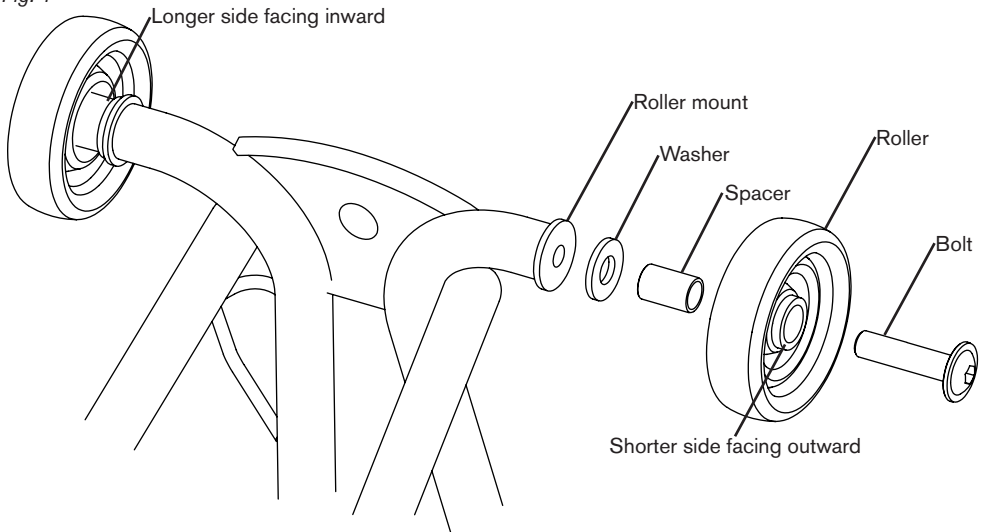
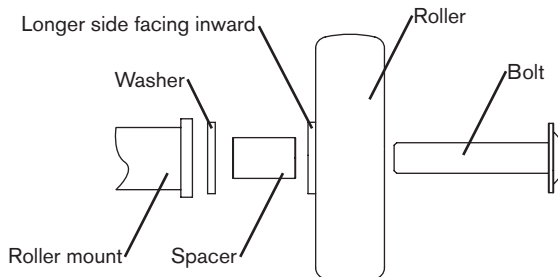

Fig. 2



## FITTING THE MUDGUARD ROLLER

This section is relevant only to L version bikes (with mudguards).

The mudguard roller should be fitted as shown (fig. 3) and you will need to remove the rear wheel or deflate the tyre to do this. This will allow you to access the nuts and catch plate. More information on removing the rear wheel can be found in datasheet **ds-rw**.

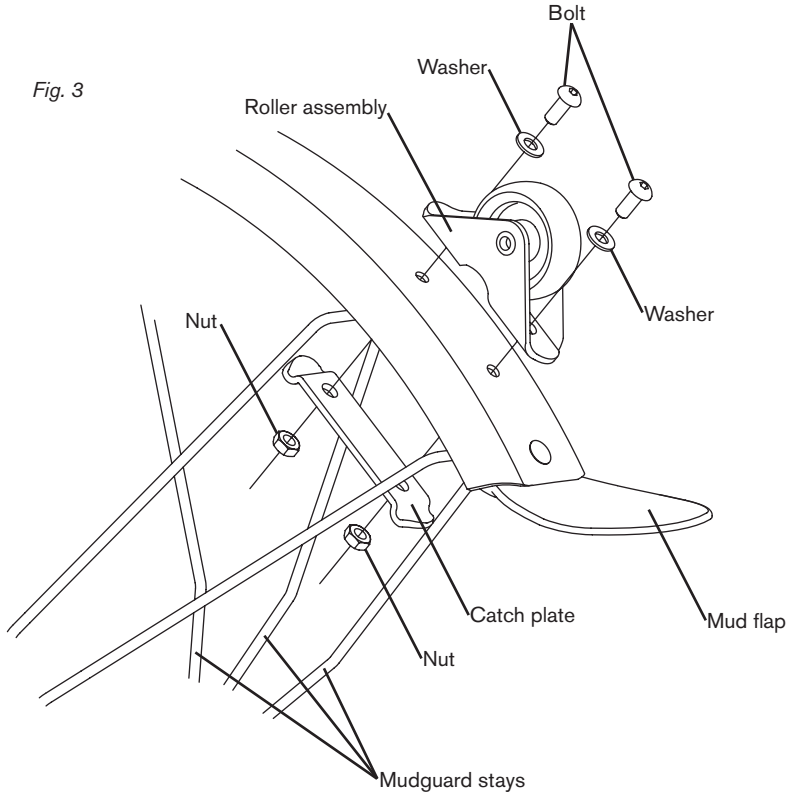

- Disassemble the original roller by undoing the two bolts on either side with a 2.5mm hex key, holding the nuts on the opposite side with an 8mm spanner
- Remove the catch plate, roller and fixings and put all the original parts to one side
- Ensure that the two mudguard stays are positioned just fore and aft of the holes in the mudguard
- Fit the new bolts washer and roller assembly together
- Assemble onto the mudguard and ensure the bolts pass through the holes in the mudguard blade
- Push the new catch plate upwards onto the underside of the mudguard blade, ensuring that the mudguard stays are held by each end of the plate
- Fit one of the nuts and tighten gently and then fit the second nut, once both nuts are engaged tighten firmly

